

A1

DO NOT SCALE

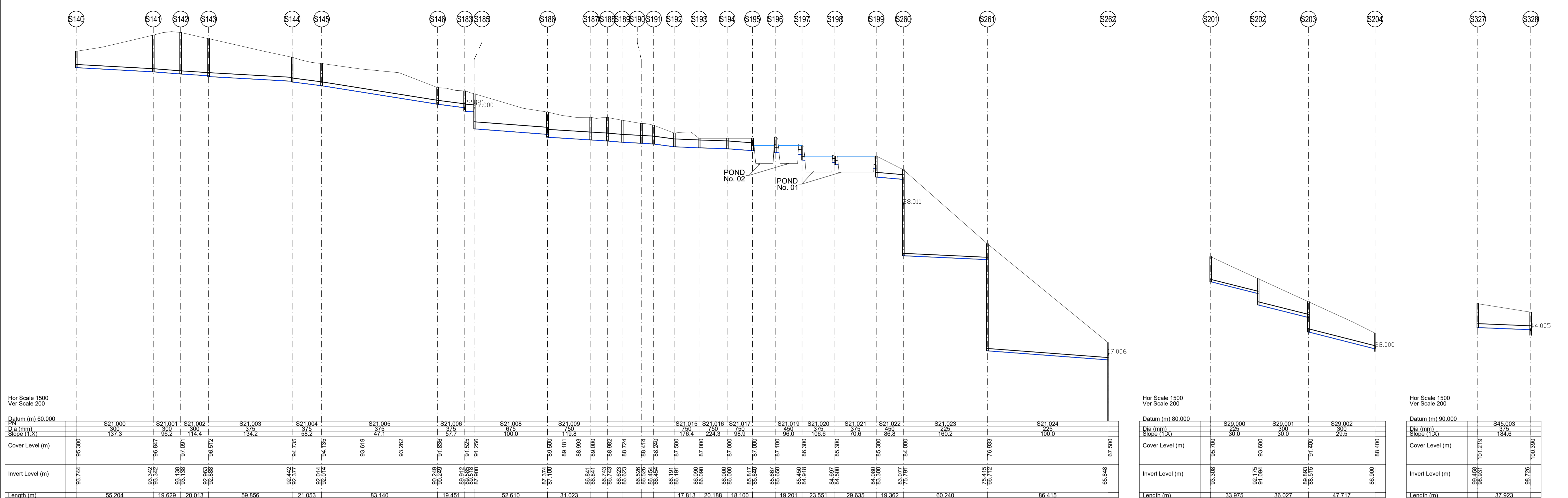

Station	Datum (m) 60.000	Dia (mm)	Slope (1:X)	Cover Level (m)	Invert Level (m)	Length (m)
S21.000	60.000	300	137.3	95.300	93.744	55.204
S21.001	60.000	300	86.2	96.877	93.512	19.629
S21.002	60.000	300	114.4	97.091	93.138	20.013
S21.003	60.000	375	134.2	96.672	92.888	59.856
S21.004	60.000	375	84.2	94.735	92.442	21.053
S21.005	60.000	375	47.1	94.135	92.014	83.140
S21.006	60.000	375	87.7	93.619	91.529	19.451
S21.008	60.000	375	100.0	93.282	91.258	52.610
S21.009	60.000	375	119.8	93.000	90.930	31.023
S21.010	60.000	375	88.893	89.181	87.101	87.374
S21.011	60.000	375	79.0	88.893	86.841	87.101
S21.012	60.000	375	89.000	88.893	86.623	86.623
S21.013	60.000	375	88.893	88.893	86.414	86.414
S21.014	60.000	375	88.893	88.893	86.205	86.205
S21.015	60.000	375	88.893	88.893	86.000	86.000
S21.016	60.000	375	88.893	88.893	85.800	85.800
S21.017	60.000	375	88.893	88.893	85.600	85.600
S21.018	60.000	375	88.893	88.893	85.400	85.400
S21.019	60.000	375	88.893	88.893	85.200	85.200
S21.020	60.000	375	88.893	88.893	85.000	85.000
S21.021	60.000	375	88.893	88.893	84.800	84.800
S21.022	60.000	375	88.893	88.893	84.600	84.600
S21.023	60.000	375	88.893	88.893	84.400	84.400
S21.024	60.000	375	88.893	88.893	84.200	84.200
S29.000	80.000	225	80.0	95.700	93.308	33.975
S29.001	80.000	225	30.0	93.800	92.175	36.027
S29.002	80.000	225	29.5	91.400	89.515	47.717
S45.003	90.000	300	184.6	101.219	98.637	37.923
S45.004	90.000	300	100.390	101.219	98.637	100.390

Longitudinal Section S140 - SM262
Scale 1:1500 (Horizontally), 1:200 (Vertically)

Station	Datum (m) 80.000	Dia (mm)	Slope (1:X)	Cover Level (m)	Invert Level (m)	Length (m)
S29.000	80.000	225	80.0	95.700	93.308	33.975
S29.001	80.000	225	30.0	93.800	92.175	36.027
S29.002	80.000	225	29.5	91.400	89.515	47.717

Longitudinal Section S201 - SM204
Scale 1:1500 (Horizontally), 1:200 (Vertically)

Station	Datum (m) 90.000	Dia (mm)	Slope (1:X)	Cover Level (m)	Invert Level (m)	Length (m)
S45.003	90.000	300	184.6	101.219	98.637	37.923
S45.004	90.000	300	100.390	101.219	98.637	100.390

Longitudinal Section S327 - SM328
Scale 1:1500 (Horizontally), 1:200 (Vertically)

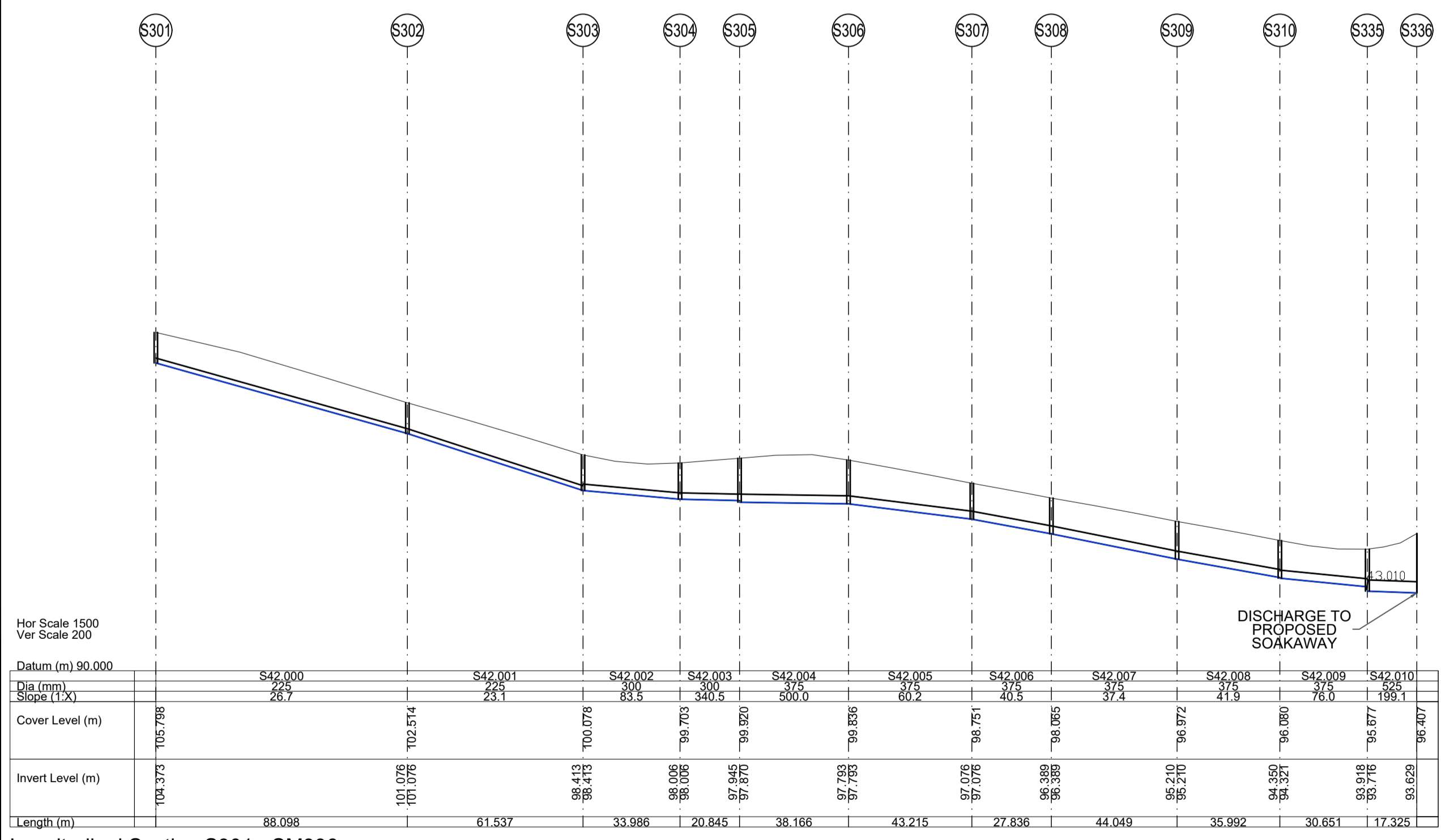

Station	Datum (m) 90.000	Dia (mm)	Slope (1:X)	Cover Level (m)	Invert Level (m)	Length (m)
S42.000	90.000	225	26.7	105.788	104.373	88.088
S42.001	90.000	225	25.1	102.514	101.076	61.537
S42.002	90.000	300	83.5	100.078	98.413	33.986
S42.003	90.000	300	340.5	99.703	98.006	20.845
S42.004	90.000	300	500.0	99.620	97.870	38.166
S42.005	90.000	300	60.2	99.836	97.793	43.215
S42.006	90.000	300	40.5	99.751	97.708	27.836
S42.007	90.000	300	37.4	99.675	97.632	44.049
S42.008	90.000	300	41.9	99.600	97.557	35.992
S42.009	90.000	300	76.0	99.525	97.482	30.651
S42.010	90.000	300	199.1	99.450	97.407	17.325

Longitudinal Section S301 - SM336
Scale 1:1500 (Horizontally), 1:200 (Vertically)

© ORDNANCE SURVEY IRELAND LICENSE No. AR 0082518
ORDNANCE SURVEY IRELAND & GOVERNMENT OF IRELAND

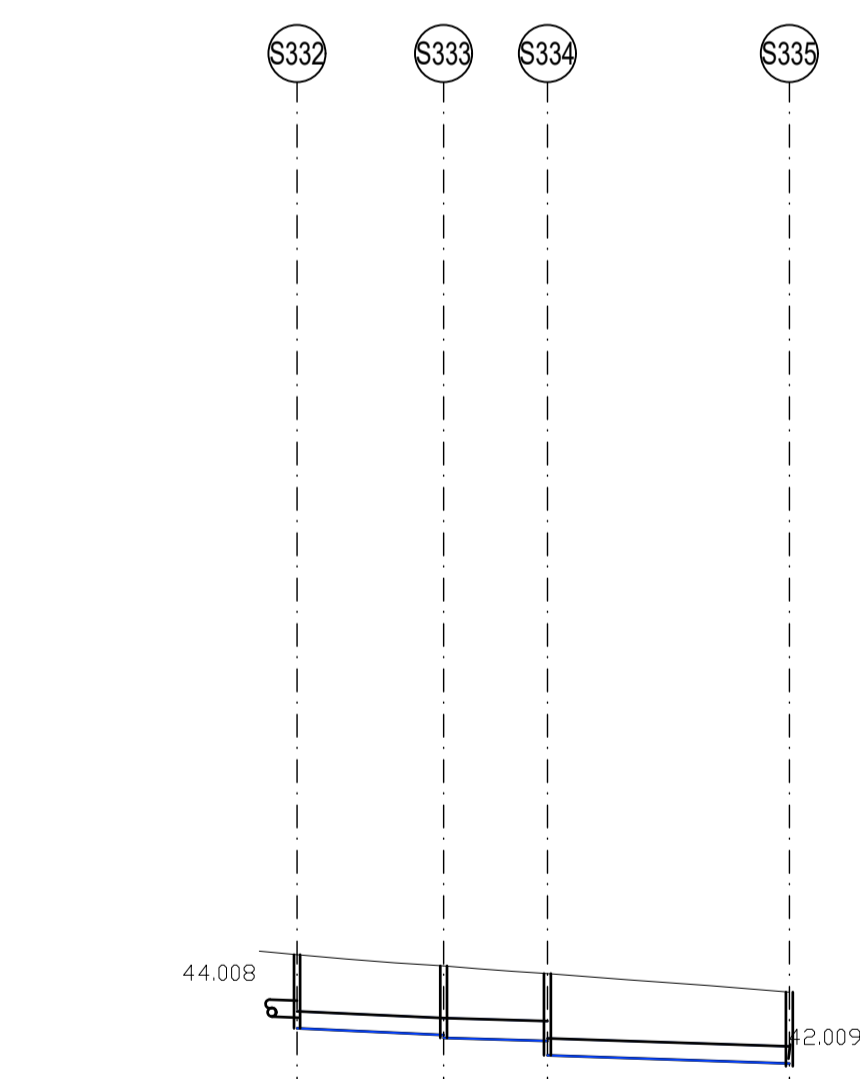

Station	Datum (m) 90.000	Dia (mm)	Slope (1:X)	Cover Level (m)	Invert Level (m)	Length (m)
S43.008	90.000	225	163.5	98.897	96.003	29.071
S43.009	90.000	225	250.0	96.370	94.467	20.597
S43.010	90.000	225	228.8	96.170	94.265	47.998

Longitudinal Section S332 - SM335
Scale 1:1500 (Horizontally), 1:200 (Vertically)

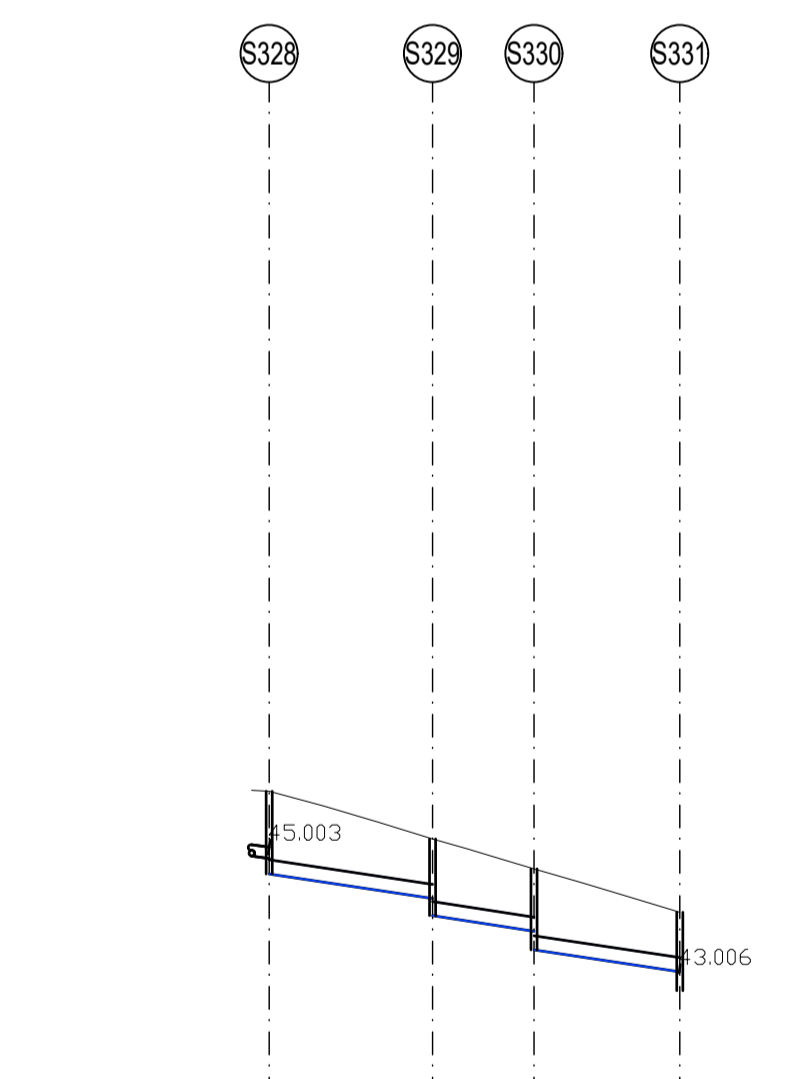

Station	Datum (m) 90.000	Dia (mm)	Slope (1:X)	Cover Level (m)	Invert Level (m)	Length (m)
S44.006	90.000	375	50.0	100.390	98.214	32.429
S44.007	90.000	375	48.5	99.729	97.100	20.126
S44.008	90.000	375	50.0	99.337	96.605	28.908

Longitudinal Section S328 - SM331
Scale 1:1500 (Horizontally), 1:200 (Vertically)

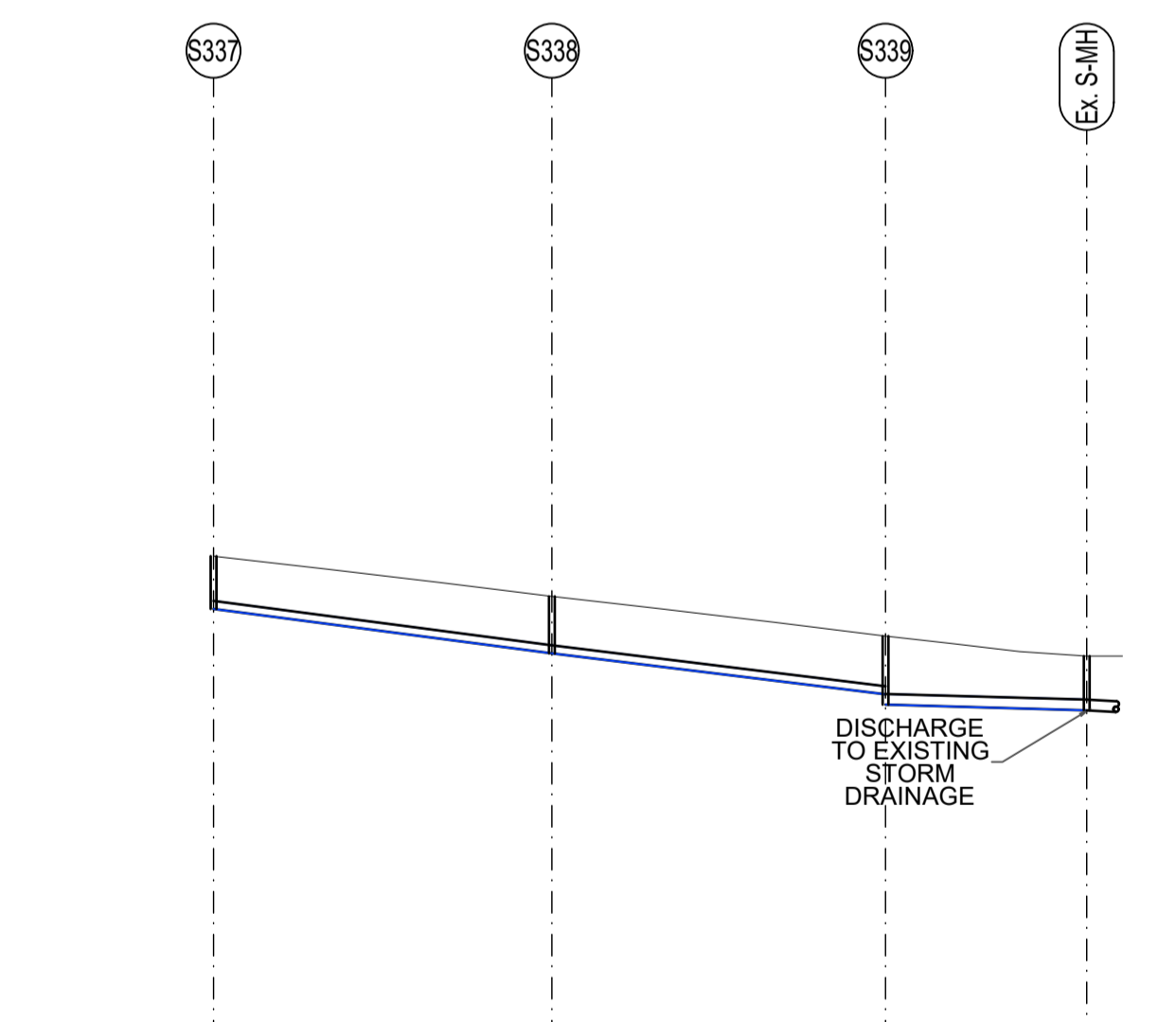

Station	Datum (m) 90.000	Dia (mm)	Slope (1:X)	Cover Level (m)	Invert Level (m)	Length (m)
S46.000	90.000	225	57.1	105.788	104.314	70.901
S46.001	90.000	225	61.3	104.887	103.073	69.921
S46.002	90.000	300	288.8	103.599	101.842	42.151

Longitudinal Section S337 - Ex. S-MH
Scale 1:1500 (Horizontally), 1:200 (Vertically)

File: S186693_HTR_01_DR_0520-0524.dwg
Date: Apr 06, 2022 - 9:45am
Plotted by: patrick.sheridan

FOR PLANNING	PS	01.04.22	AC	GH	
Rev	Description	By	Date	Chkd	Auth

SNC-LAVALIN
Member of the SNC-Lavalin Group

ATKINS

Atkins House, 150-155 Ainslie Business Park, Swords, Co. Dublin
Tel (+353) 01 810 8000 Fax (+353) 01 810 8001

Unit 2B, 2200 Cork Airport Business Park, Cork
Tel (+353) 021 429 0300 Fax (+353) 021 429 0360

2nd Floor Technology House Parkmore Technology Park, Galway
Tel (+353) 091 786 050 Fax (+353) 091 779 830

Cosgrave

FASSAROE DEVELOPMENT

Purpose	PLANNING						
Title	PHASE 1 PROPOSED STORM WATER LONGSECTIONS SHEET 4						
Original Scale	AS SHOWN	Design/Drawn	PS	Checked	AC	Authorized	GH
Status	P	Date	22.11.21	Date	22.11.21	Date	22.11.21
Drawing Number	5186693 / HTR / 01 / DR / 0523			Rev	-		